

**OFFICER DELEGATION SCHEME
RECORD OF OPERATIONAL DECISION**



TO BE UPLOADED TO THE E-MEETINGS MANAGER

Date: 14.05.19	Ref No: 3308
Type of Operational Decision:	
Executive Decision <input checked="" type="checkbox"/>	Council Decision <input type="checkbox"/>
Status: for publication	
Title/Subject matter: Temporary Closures, temporary prohibition of waiting, residential permit holders parking areas, Temporary Clearways and Hackney Carriage Stand – Various Roads, Prestwich for Heaton Park Events – Noel Gallagher 07 June 2019, Parklife 08 June to 09 June 2019 and Courteeners 15 June 2019.	
Budget/Strategy/Policy/Compliance – Is the decision:	
(i) within an Approved Budget	✓
(ii) not in conflict with Council Policy	✓
(iii) not raising new issues of Policy	✓
Equality Analysis [Does this decision change or make policy; change or make procedure or working practice? An Equality Analysis must be completed to assess the impact on equality and the relevance of the Public Sector Equality Duty. This should be signed off by your departmental equality representative and accompany this decision form. Please forward a copy to the Equality email for publication].	No
	Signed: (By EA Officer) Date:
Details of Operational Decision Taken [with reasons]:	
Approval to the temporary closures, temporary prohibition of waiting, temporary clearways and temporary Hackney Carriage Stand under Section 14(2) of the Road Traffic Regulation Act 1984 on various streets in Prestwich (see attached schedule) for Heaton Park Events (07 June 2019, 08 June to 09 June 2019 and 15 June 2019) to assist traffic management movement and maintain public safety in connection with the Noel Gallagher, Parklife and Courteeners Events in Heaton Park.	
Decision taken by: D. Brown	Signature:
D R Giblin – Head of Engineering	17/05/19
Members Consulted [see note 1 below]	

Cabinet Member/Chair		
Lead Member		
Opposition Spokesperson		

Notes

1. It is not generally a requirement to consult with any Members on Operational Decisions but where an Executive Director considers it necessary to consult with the appropriate Cabinet Member and/or Lead Member, they must sign the form so as to confirm that they have been consulted and that they agree with the proposed action. The signature of the Opposition Spokesperson should be obtained to confirm that he/she has been consulted.
2. **This form must not be used for urgent decisions.**

January 2015

**BURY COUNCIL
PROPOSED TEMPORARY TRAFFIC CONTROL BY NOTICE
ROAD TRAFFIC REGULATION ACT 1984 SECTION 14(2)**

<p>Name and Lengths of Road(s) Affected</p>	<p>1) Temporary Closure - Scholes Lane and Meade Hill Road, Prestwich – full length (Friday, Saturday & Sunday 07, 08, 09 June 2019, Saturday 15 June 2019 09.00hrs-00.00hrs and 00.00 hrs-01.00hrs Monday 10 June 2019 and Sunday 16 June 2019)</p> <p>Bury Old Road, Prestwich (southbound) – between Heys Road and Sheepfoot Lane (Friday, Saturday & Sunday 07, 08 & 09 June 2019 and Saturday 15 June 2019 21.30hrs-23.30hrs)</p> <p>Whittaker Lane – between Bent Lane and its junction with Bury Old Road (Friday, Saturday & Sunday 07, 08 & 09 June 2019, Saturday 15 June 2019 09.00hrs – 01.00hrs and Monday 10 June 2019 and Sunday 16 June 2019 00.00hrs-01.00hrs)</p> <p>2) Temporary Closure (Prohibition of Driving) – Sheepfoot Lane, Prestwich – full length (Friday, Saturday & Sunday 07, 08 & 09 June 2019, Saturday 15 June 2019 09.00hrs-01.00hrs and Monday 10 June 2019 and Sunday 16 June 2019 00.00hrs-01.00hrs)</p> <p>3) Temporary No Waiting – St Margaret’s Road – southerly/easterly sides from its junction with Bury Old Road to its junction with Heywood Road including the Bell Mouth entrance of Heaton Park, St Margaret’s Gate.</p> <p>St Margaret’s Close – full length</p> <p>Carver Avenue, Prestwich – full length</p> <p>Park Place, Prestwich – full length</p> <p>Scholes Lane – Bury Old Road to Bishops Road</p> <p>Middleton Road Service Road – easterly/southerly sides from Baguley Crescent to the bend adjacent to the M60 motorway boundary</p> <p>Side roads off Sheepfoot Lane – Beechwood Road, Park Road (Sheepfoot Lane to 50 metres in a southerly direction), Eastleigh Road and Edgeware Avenue (for the first 50 metres into each junction from its junction with Sheepfoot Lane).</p> <p>(Friday, Saturday & Sunday 07, 08 & 09 June 2019 and Saturday 15 June 2019 09.00hrs-01.00hrs and Monday 10 June 2019 and Sunday 16 June 2019 00.00hrs-01.00hrs)</p> <p>4) Temporary Closure (Prohibition of Driving) and</p>
---	---

Residential Permit Holders Parking areas:

Bury Old Road (St Margaret's Road to Salford boundary)
Whittaker Lane (junction with Bury Old Road to Bent Lane), Ogden Street, Park Street, Infant Street, Blackburn Street, Bent Lane, Ostrich Lane, Hope Park Road, Beech Close, High Bank Crescent, High Bank Grove, Green Walks, Upper Wilton Street, Wiseman Terrace, Wilton Street and Newtown Street (Bailey Street to Bury Old Road), Beaufort Street, Elizabeth Street, Rectory Lane (Whittaker Lane to Bent Lane), Store Street, Whittaker Close

Tudor Court, Sedgley Park Road, Wells Avenue, Holmefield Avenue, Meadfoot Avenue, Hereford Drive, Lincoln Drive, Lancaster Drive, Cranbrook Drive, Parkway, Hartley Avenue, Bishops Road, West Meade, Tewkesbury Drive, Salisbury Drive, Fairway, Linksway, East Meade, South Meade, Queens Drive, Rochester Avenue, Dorchester Avenue, Colchester Avenue, Winchester Avenue, King's Road, Mather Avenue, Richmond Avenue, Mildred Avenue, Mowbray Avenue, Princess Avenue, Sedgley Avenue, Harrogate Avenue, Albert Avenue, York Avenue, Fort Road, Hardman Avenue, Wilton Avenue, Parkfield Avenue, Canterbury Drive, Lichfield Drive, Dellcot Close, Beechcroft Avenue, Stobart Avenue, Back Bury New Road (Kings Road to cul-de-sac end), Woodhill drive, Breezemount, Woodhill Grove and Overbrook Drive

St Margaret's Road, St Margaret's Close, Bannerman Avenue, The Meadows, Carlton Drive and Carlton Avenue, Holyrood Road (Bury Old Road to Knight's Close), Knight's Close, Milton Road and Merton Road

Edgware Avenue, Watkins Drive, Hillwood Avenue, Meade Hill Road, Whitehouse Avenue, Eastleigh Road, Downham Crescent, Beechwood Road, Northleigh Drive (Sheepfoot Lane to Downham Crescent) Oakfield, Westleigh Drive, Charlbury Avenue, Dovedale Avenue, Windsor Road, Windsor Crescent, Cragwell Road, Belfield Road, Silverdale Avenue, Edenfield Road, Brooklands Road, Park Road (Sheepfoot Lane to Carlton Drive), Castle Hill Road, Bury Old Road, Sandringham Grange, Danesway, Ravensway and Ravens Close

Balmoral Grange, Northleigh Drive, Norton Grange, Marton Grange, Lyndhurst Avenue, Newington Avenue, Mosslee Avenue, Northurst Drive, Woodthorpe Grange, Woodthorpe Court, Scholes Lane, Links Crescent and Downham Gardens, Parkfield Avenue, Scholes Walk, The Residences, Beechwood Road, Oakfield

Baguley Crescent, Service Road between Middleton Road and Baguley Crescent

(No waiting except permit holders (Friday, Saturday & Sunday 07, 08 & 09 June 2019 and Saturday 15 June 2019 **09.00hrs-01.00hrs** and Monday 10 June 2019 and Sunday 16 June 2019 **00.00hrs-01.00hrs** & Temporary

	<p>Closures/Prohibition of Driving 20.00hrs-01.00hrs)</p> <p>5) Temporary Clearway Order</p> <p>Sheepfoot Lane, Prestwich – full length Meade Hill Road, Prestwich – full length</p> <p>(Friday, Saturday & Sunday 07, 08 & 09 June 2019 and Saturday 15 June 2019 09.00hrs-00.00hrs and Monday 10 June 2019 and Sunday 16 June 2019 00.00hrs-01.00hrs)</p> <p>6) Temporary Hackney Carriage Stand</p> <p>Bury Old Road – lay-by outside the Woodthorpe Public House</p> <p>(Friday, Saturday & Sunday 07, 08 & 09 June 2019 09.00-01.00hrs and Monday 10 June 2019 and Sunday 16 June 2019 00.00hrs-01.00hrs)</p> <p>7) Residential Permit Holders Parking areas: Temporary No Waiting except permit holders</p> <p>St Margarets Road, St Margarets Close, Carver Avenue</p> <p>(No waiting except permit holders (Friday, Saturday & Sunday 07, 08 & 09 June 2019 09.00hrs-01.00hrs and Monday 10 June 2019 and Sunday 16 June 2019 00.00hrs-01.00hrs)</p>
Reason for Notice/Order	In order to assist traffic management movement and maintain public safety in connection with Heaton Park Events 07 June 2019 (Noel Gallager) 08 & 09 June 2019 (Parklife) and 15 June 2019 (Courteeners).
Nature of Notice/Order	As above
Period of Notice/Order	<ol style="list-style-type: none"> 1) Temporary closures all days listed above (09.00 – 01.00 hrs, approximately) 2) Temporary closure 07, 08 and 09 June 2019 and 15 June 2019 (0900 to 0100) as and when required 3) Temporary no waiting 07, 08 and 09 June 2019 and 15 June 2019 (09.00 to 01.00 hrs) 4) Temporary closure (20.00 to 0100) (except permit holders) all days (09.00 to 0100 hrs) 5) Temporary clearway (09.00hrs – 0100hrs) 6) Temporary Hackney Carriage Stand (09.00hrs – 0100hrs) 7) Temporary no waiting (except permit holders) all days (09.00 to 01.00hrs)
Date of Commencement of Notice/Order	Friday 07 June 2019
Anticipated Duration of Works	Friday 07 June 2019 10.00 to Monday 11 June 2019 0100 hrs and Saturday 15 June 10.00 to Sunday 16 June 0100hrs
Is the Emergency Procedure	YES/NO Note: For an unforeseen crisis a road may be

being invoked?	closed for up to 21 days		
Is a Temporary Order to be made?	YES/NO		
Description of Alternative Route(s)	1) Via Bury New Road and Bury Old Road and vice versa. Bury Old Road, Heys Road, Heywood Road and Rectory Lane and vice-versa Via Bury Old Road and Middleton Road and vice-versa 2) Via Bury Old Road and Middleton Road and vice- versa 3) - 7) (N/A)		
	YES/NO		
Name of Person to be Contacted for Further Information.	Joe Goldstone Tel: 0161-253-5830		
Emergency Closures - Have the following been informed?	Police	YES/NO	
	Fire	YES/NO	NOT
	Ambulance	YES/NO	APPLICABLE
	TfGM	YES/NO	
	Streetworks	YES/NO	
Recharge Code	465 HAM2000 5641 TRT		

Engineering Manager  Date 17/05/19

Delegated Powers Form Ref No 3308

Sheepfoot Lane Area, Prestwich Temporary Closures and Waiting Restrictions

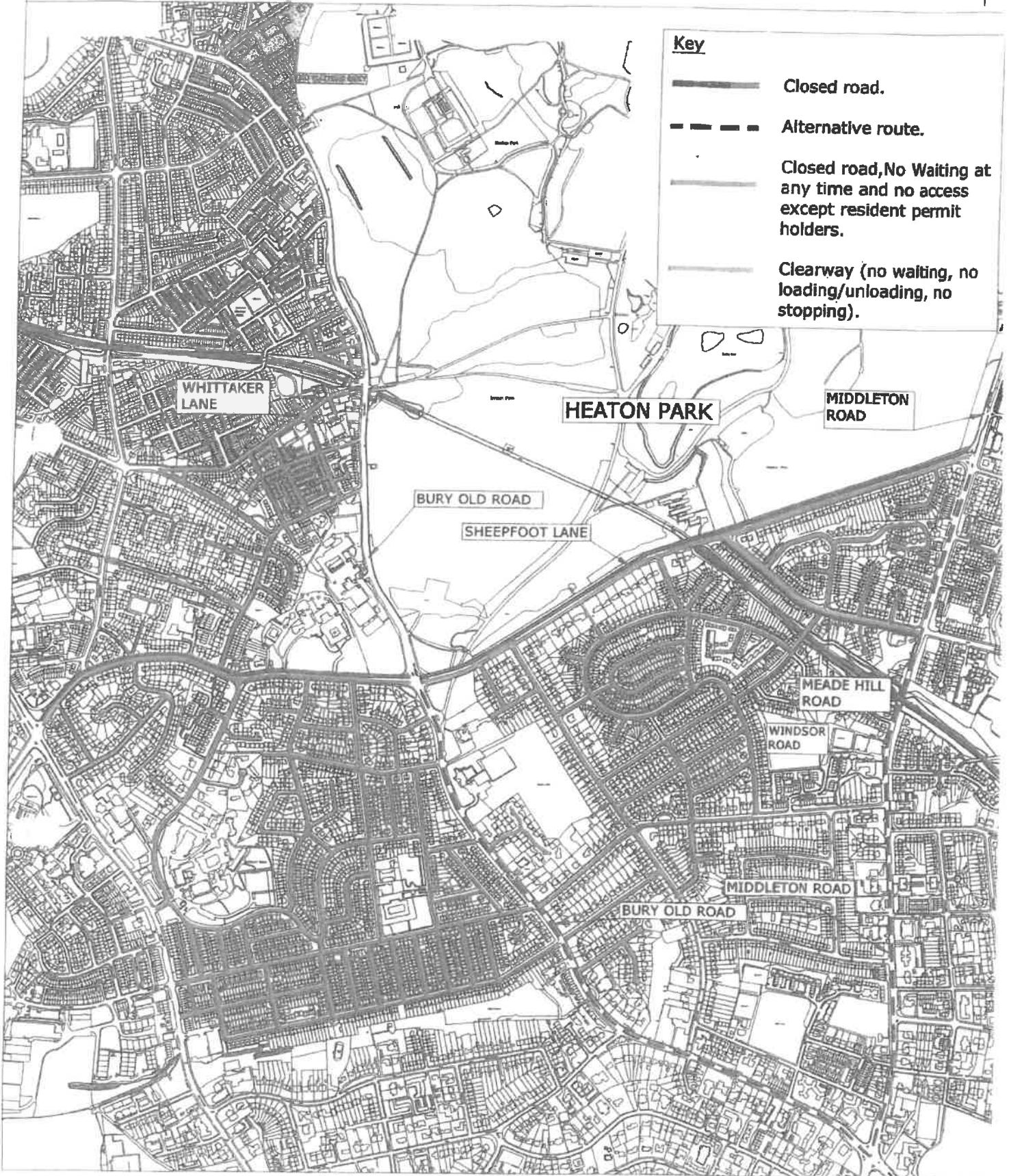

Key

- Closed road.
- Alternative route.
- Closed road, No Waiting at any time and no access except resident permit holders.
- Clearway (no waiting, no loading/unloading, no stopping).

© Crown Copyright and database right 2016. Ordnance Survey 100023063

PLAN TM8693/1
 DATE 16.05.17
 DRAWN MRT
 SCALE NTS

DEPARTMENT FOR RESOURCES AND REGULATION

3 Knowsley Place
 Duke Street,
 BURY BL9 0EJ

Tel: 0161 253 5353
 Fax: 0161 253 7963



PHOTOGRAPHIC COPY LIABLE TO DISTORTION IN SCALE

**Prestwich
Diversion route**

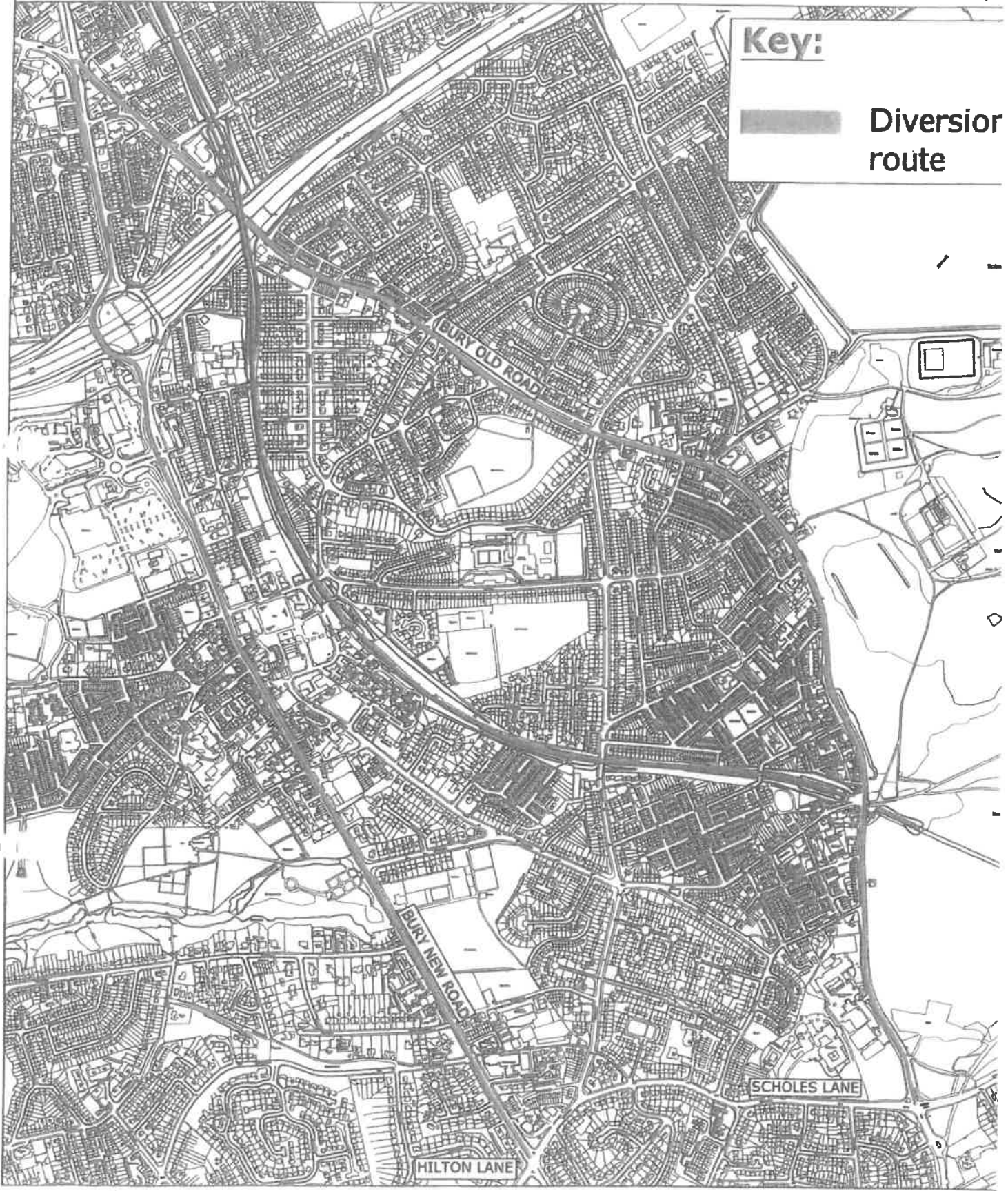

Key:



**Diversion
route**

© Crown Copyright and database right 2015. Ordnance Survey 100023063

PLAN TM8693/2
DATE 16.05.17
DRAWN MRT
SCALE NTS

PHOTOGRAPHIC COPY LIABLE TO DISTORTION IN SCALE

DEPARTMENT FOR RESOURCES AND REGULATION

3 Knowsley Place
Duke Street;
BURY BL9 0EJ

Tel: 0161 253 5353
Fax: 0161 253 7963

Bury
COUNCIL

Sheepfoot Lane Area, Prestwich Temporary Waiting Restrictions

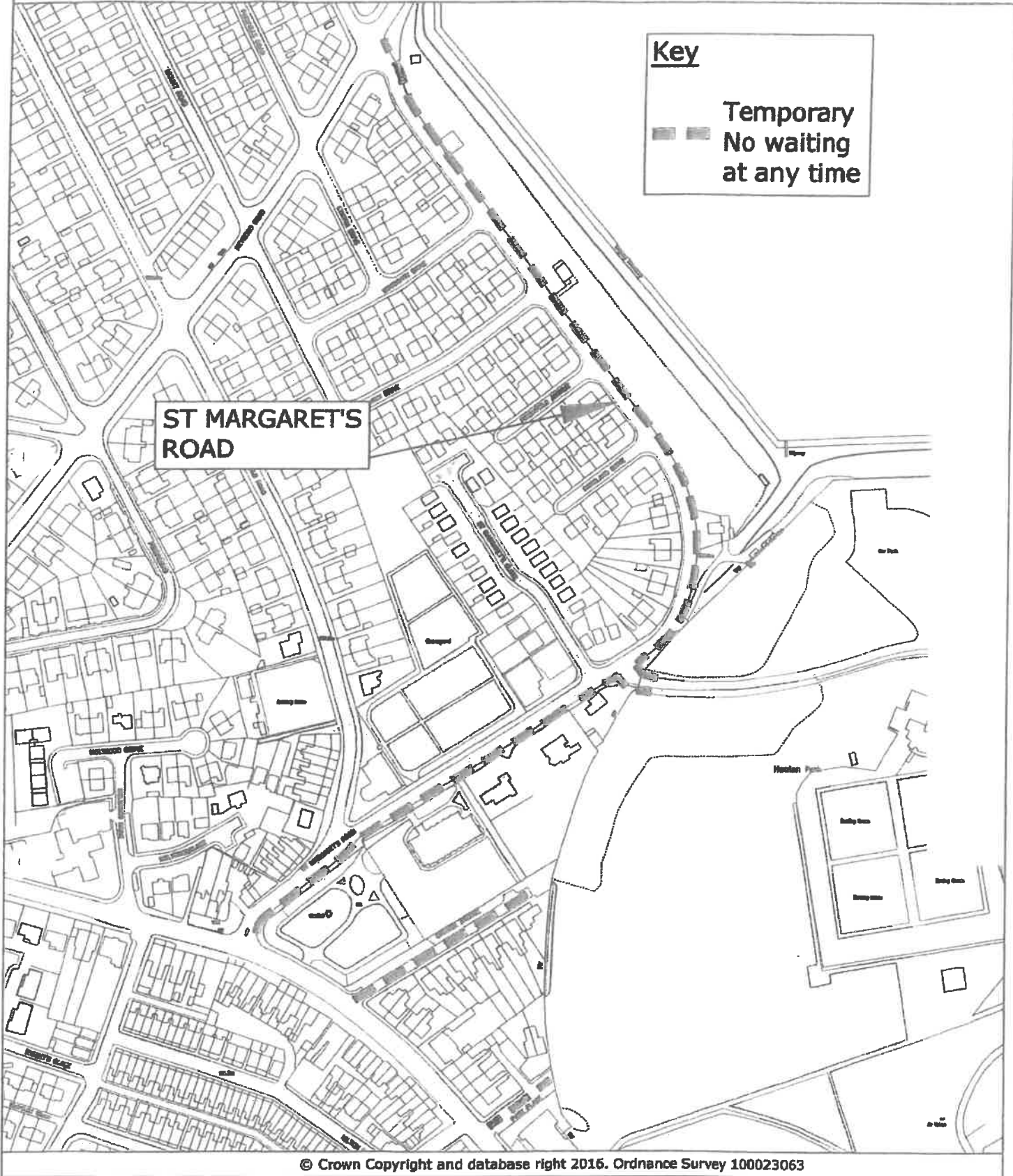

© Crown Copyright and database right 2016. Ordnance Survey 100023063

PLAN TM8693/3
DATE 16.05.17
DRAWN MRT
SCALE NTS

DEPARTMENT FOR RESOURCES AND REGULATION

3 Knowsley Place
Duke Street,
BURY BL9 0EJ

Tel: 0161 253 5353
Fax: 0161 253 7963



Bury
COUNCIL

PHOTOGRAPHIC COPY LIABLE TO DISTORTION IN SCALE

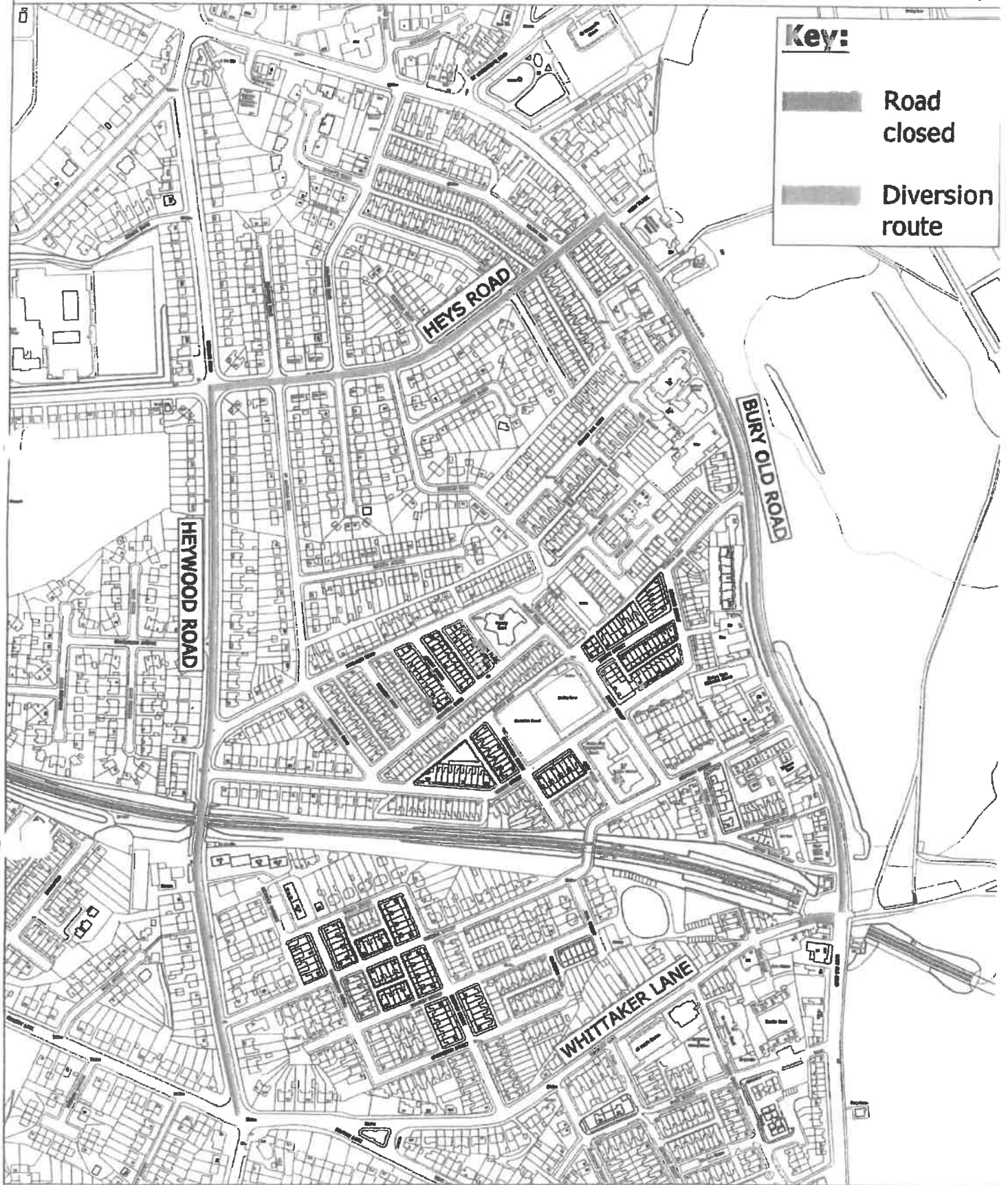
Whittaker Lane, Prestwich Diversion route



Key:

-  Road closed
-  Diversion route

© Crown Copyright and database right 2015. Ordnance Survey 100023063

PLAN TM8693/4
DATE 16.05.17
DRAWN MRT
SCALE NTS

DEPARTMENT FOR RESOURCES AND REGULATION

3 Knowsley Place
Duke Street,
BURY BL9 0EJ

Tel: 0161 253 5353
Fax: 0161 253 7963



PHOTOGRAPHIC COPY LIABLE TO DISTORTION IN SCALE

Sheepfoot Lane Area, Prestwich Temporary Waiting Restrictions



Key

 Temporary No waiting at any time.

 Closed road and No Waiting except permit holders.

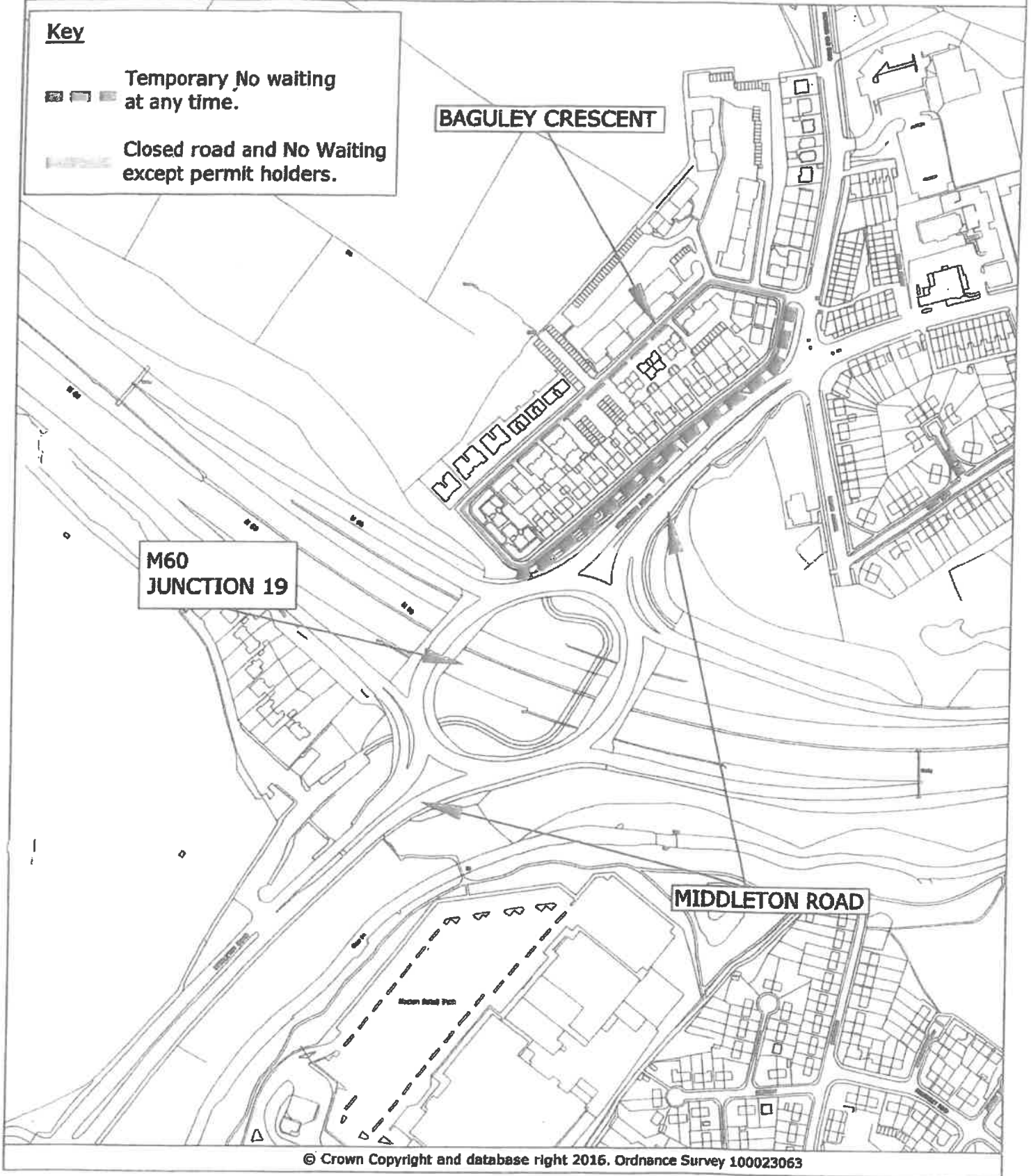

© Crown Copyright and database right 2016. Ordnance Survey 100023063

PLAN TM8693/4
 DATE 16.05.17
 DRAWN MRT
 SCALE NTS

DEPARTMENT FOR RESOURCES AND REGULATION

3 Knowsley Place
 Duke Street,
 BURY BL9 0EJ

Tel: 0161 253 5353
 Fax: 0161 253 7963

Bury
 COUNCIL

